

Marchio / Brand ZUCCHETTI

Classe / Class

JINGLE

## JINGLE

ZIN662

Termostatico incasso doccia con 4 rubinetti d'arresto. / Built-in thermostatic shower mixer with 4 stop valves.



Termostatico incasso doccia da 1/2", con 4 rubinetti d'arresto.







1/2" built-in thermostatic shower mixer with 4 stop valves.

R97823

Parte incasso. / Built-in part.

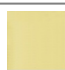

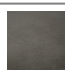
### Finiture / Finishes

						
Cromo / Chrome	Nickel Spazzolato / Brushed Nickel	Nickel Lucido / Polished Nickel	Gold / Gold	Brushed Gold / Brushed Gold	Metal Black / Metal Black	Brushed Metal Black / Brushed Metal Black
						
Bianco Opaco Goffrato / Emb. Matt White	Nero Opaco Goffrato / Emb. Matt Black					

## JINGLE

ZIN662

Disegno Complessivo / Overall Drawing

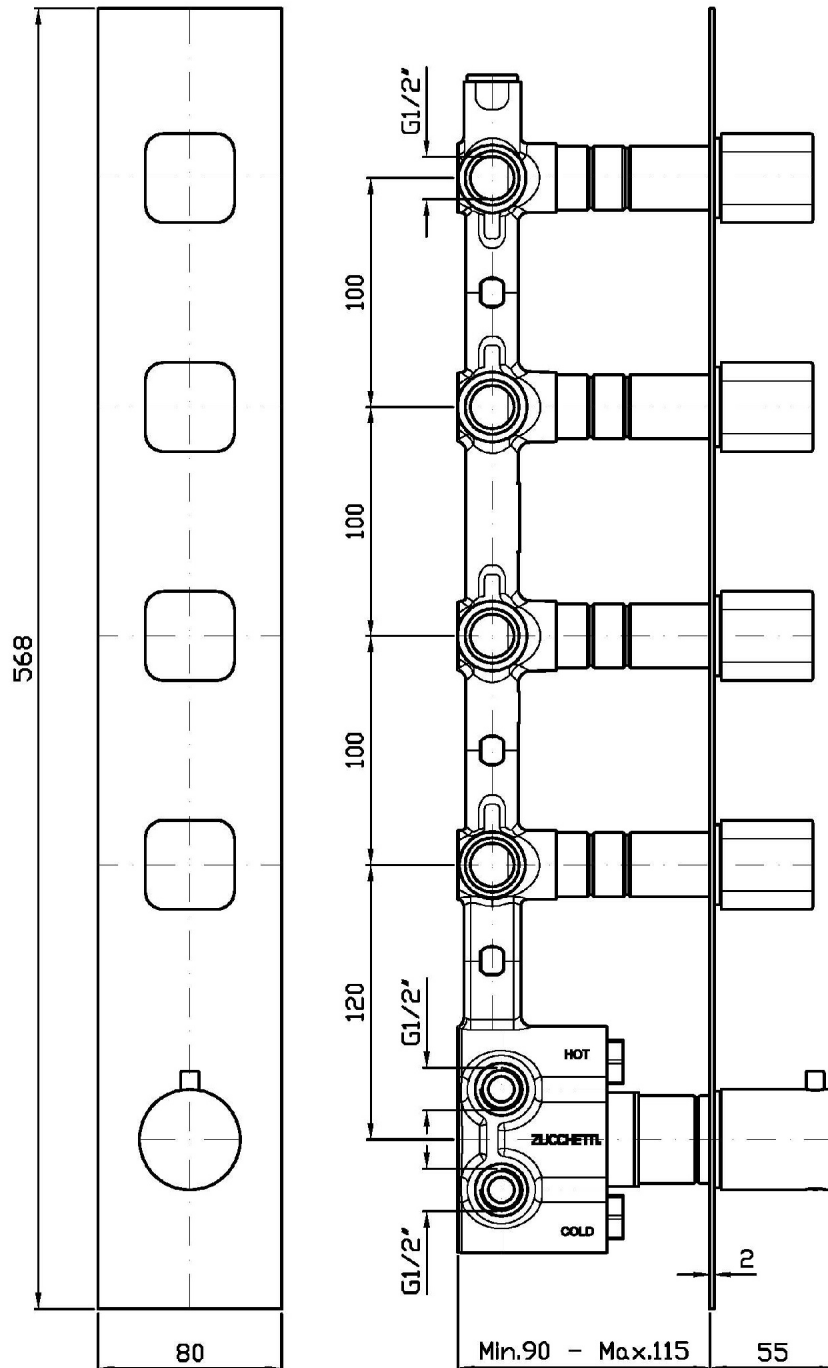

## JINGLE

ZIN662

Esplosi / Exploded

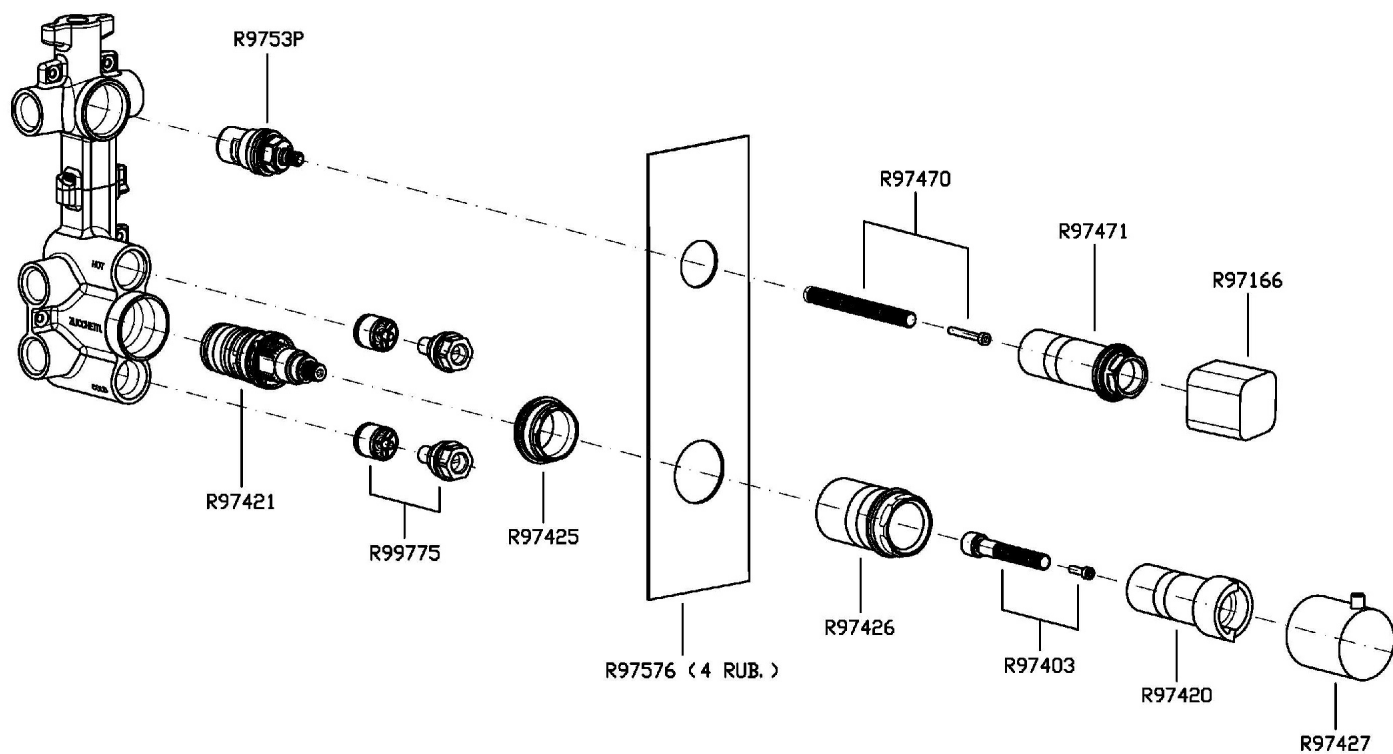

## JINGLE

### ZIN662 Portate / Flowrates (lt/min)

PRESSIONE PRESSURE	1 BAR	2 BAR	3 BAR	4 BAR	5 BAR
1 RUBINETTO APERTO <i>P1</i> 1 STOP VALVE OPEN	13,2	18,4	22,7	26,2	29,2
2 RUBINETTO APERTI <i>P2</i> 2 STOP VALVES OPEN	16,5	23,6	29	33,3	37,6
3 RUBINETTO APERTI <i>P3</i> 3 STOP VALVES OPEN	17,7	25,3	31,3	36,2	40,4
4 RUBINETTO APERTI <i>P4</i> 4 STOP VALVES OPEN	18,5	26	31,9	36,9	41,3
<i>P5</i>					

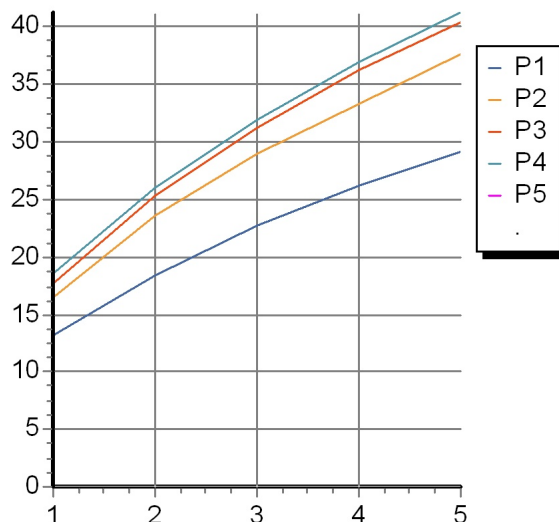

## JINGLE

### ZIN662 Pesì e Misure / Weights and Sizes

Peso ( Kg ) Weight ( lb )	2,2 ( Kg )	4,85012 ( lb )
Volume ( dc3 ) - ( in3 )	15,13 ( dc3 )	0,000923 ( in3 )
h ( mm ) - ( in )	140 ( mm )	5,511814 ( in )
L1 ( mm ) - ( in )	180 ( mm )	7,086618 ( in )
L2 ( mm ) - ( in )	600 ( mm )	23,62206 ( in )

