

Marchio / Brand ZUCCHETTI

Classe / Class

JINGLE

## JINGLE

ZIN661

Termostatico incasso doccia con 3 rubinetti d'arresto. / Built-in thermostatic shower mixer with 3 stop valves.



Termostatico incasso doccia da 1/2", con 3 rubinetti d'arresto.







1/2" built-in thermostatic shower mixer with 3 stop valves.

R97822

Parte incasso. / Built-in part.

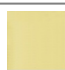

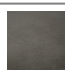
### Finiture / Finishes

						
Cromo / Crhome	Nickel Spazzolato / Brushed Nickel	Nickel Lucido / Polished Nickel	Gold / Gold	Brushed Gold / Brushed Gold	Metal Black / Metal Black	Brushed Metal Black / Brushed Metal Black
						
Bianco Opaco Goffrato / Emb. Matt White	Nero Opaco Goffrato / Emb. Matt Black					

## JINGLE

ZIN661

Disegno Complessivo / Overall Drawing

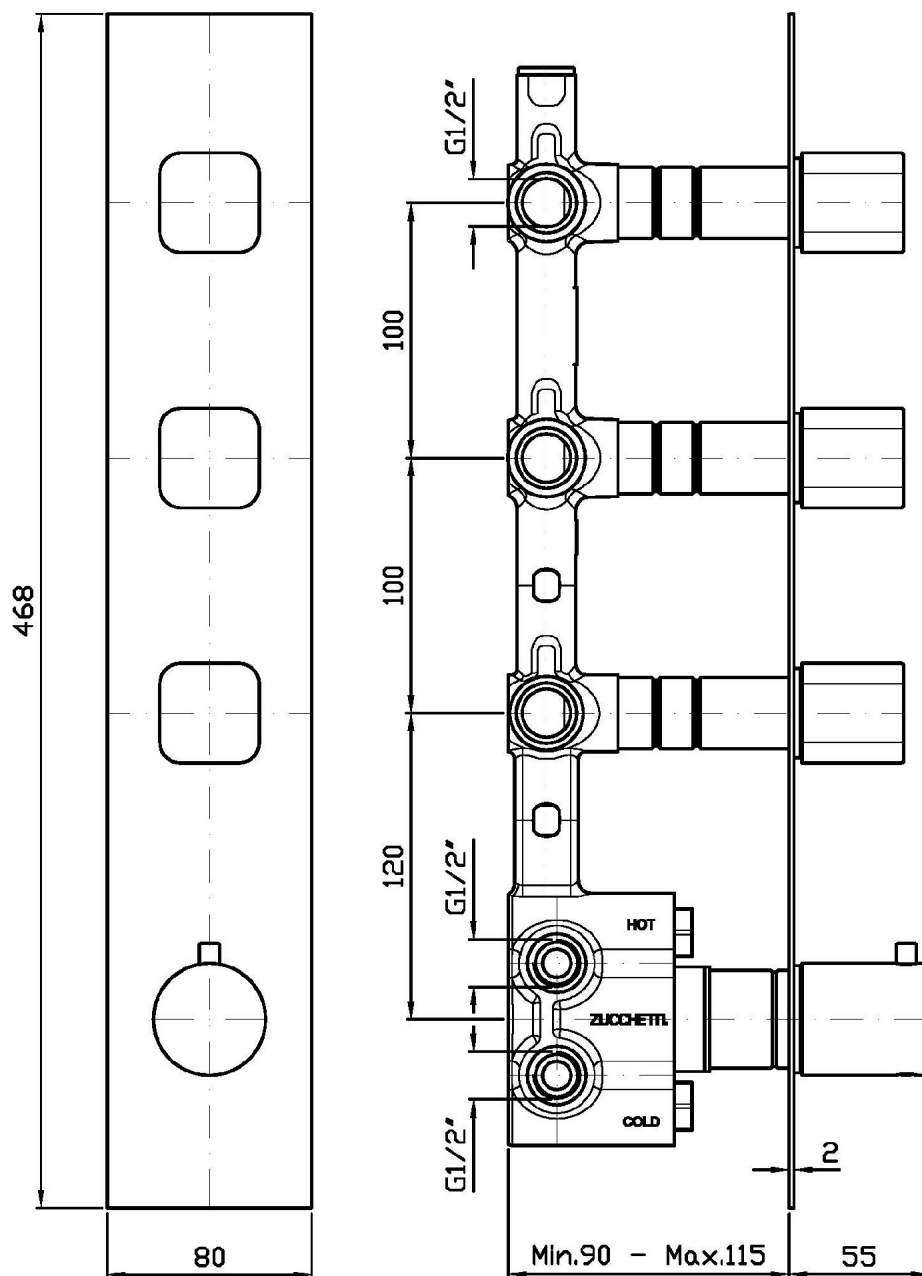

## JINGLE

ZIN661

Esplosi / Exploded

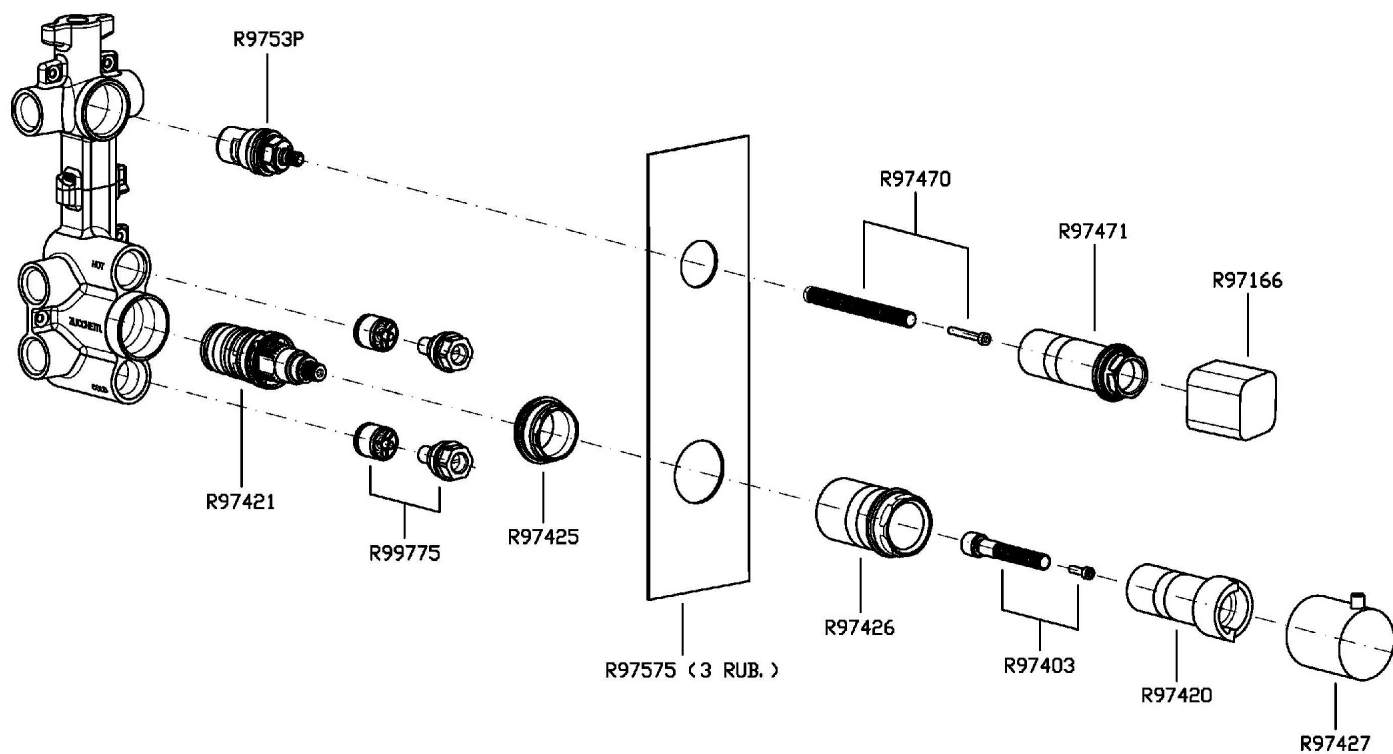

## JINGLE

### ZIN661 Portate / Flowrates (lt/min)

PRESSIONE PRESSURE	1 BAR	2 BAR	3 BAR	4 BAR	5 BAR
1 RUBINETTO APERTO P1 1 STOP VALVE OPEN	13,2	18,4	22,7	26,2	29,2
2 RUBINETTO APERTI P2 2 STOP VALVES OPEN	16,5	23,6	29	33,3	37,6
3 RUBINETTO APERTI P3 3 STOP VALVES OPEN	17,7	25,3	31,3	36,2	40,4
P4					
P5					

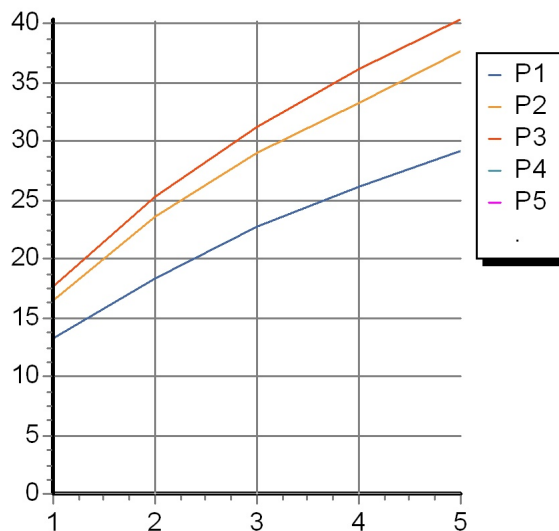

## JINGLE

### ZIN661 Pesì e Misure / Weights and Sizes

Peso ( Kg ) Weight ( lb )	1,9 ( Kg )	4,18874 ( lb )
Volume ( dc3 ) - ( in3 )	15,98 ( dc3 )	0,000975 ( in3 )
h ( mm ) - ( in )	90 ( mm )	3,543309 ( in )
L1 ( mm ) - ( in )	335 ( mm )	13,1889835 ( in )
L2 ( mm ) - ( in )	530 ( mm )	20,866153 ( in )

